

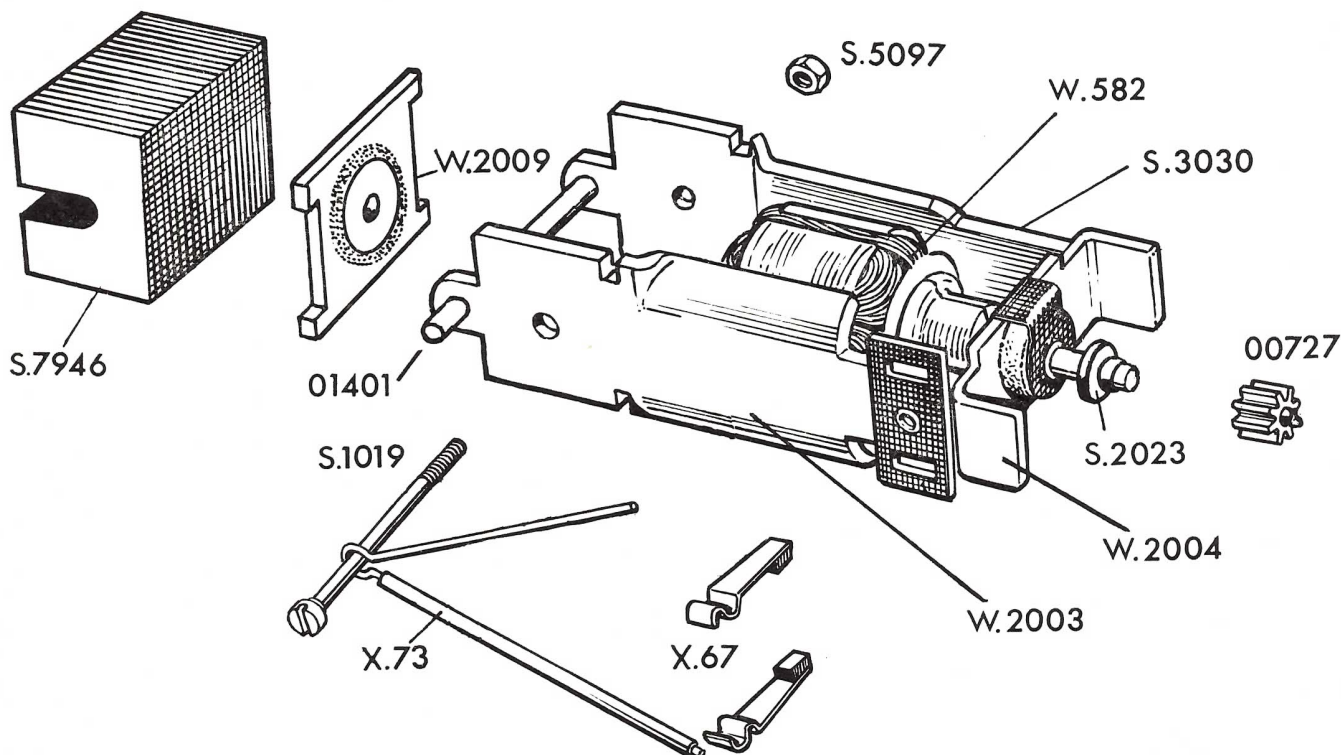

## W.581 R.X. MOTOR



W.582	Armature
W.2003	Top Pole Piece with Diaphragm
W.2004	Front Plate and Bearing
W.2009	Back Plate and Bearing
X.67	Carbon Brush
X.69	Diaphragm and Eyelet (Shown as part of W.2003)
X.73	Brush Spring and Insulator
S.1019	Magnet Screw
S.2023	Thrust Bush
S.3030	Bottom Pole Piece
S.5097	8 BA Nut
S.7946	Magnet
00727	Pinion
01401	Motor Mounting Pin

Modifications are made from time to time to Rovex Triang models. If a spare part is required which does not coincide with the illustration, a full description should be given and, if necessary a sketch or sample should accompany the order. The parts which comprise an "X" or "W" assembly are not available as separate items unless the individual parts are numbered.

Printed in England



ROVEX TRI-ANG LIMITED — MARGATE  
WESTWOOD, MARGATE, KENT, ENGLAND

SERVICE SHEET No. S.1  
Issued April, 1971